

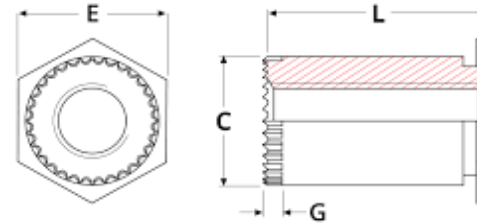

Self Clinching Grounding Standoffs



Self Clinching Grounding Standoffs							
Thread Code	Thread Size Or Through Diameter	Minimum Sheet Thickness	C +0 -0.13	G Nominal	E Nominal	Hole Size +0.08 -0.0	Min. CL To Edge Of Panel
5.4M3	M3 x 0.5	1.00	5.39	0.75	6.40	5.41	6.80

Available Lengths (L) : 3 - 4 - 5 - 6 - 8 - 10 And 12 (+0.25)

Material: Steel Electro Zinc Plated
Steel Electro Zinc Plated 
Suitable For Installation In Ductile Panels With A Maximum Recommended Hardness 80 HRB
Material : Series 300 Stainless Steel
Suitable For Installation In Ductile Panels With A Maximum Recommended Hardness 80 HI 70 HRB
Material : Aluminium
Suitable For Installation In Ductile Panels With A Maximum Recommended Hardness 80 HI 50 HRB

Self Clinching Grounding Standoffs Provide Strong Captivated Reusable Female Threads In A Spacer Format In Panels As Thin As 1.0mm.

Ideal For Use In Applications With Chassis-To-Ground Printed Circuit Boards.

Featuring Projecting Teeth Ensure Strong Electrical Conductivity With Board's Circuitry, Eliminating The Need For Additional Loose Hardware Such As Serrated Or Star Washers For Example.

INFORMATION AND DRAWINGS PROVIDED ARE REFERENCE ONLY